

**Szpilka dwustronna**  
**Шпилька с двухсторонней резьбой**  
**Double sidethreaded rod**

**038**

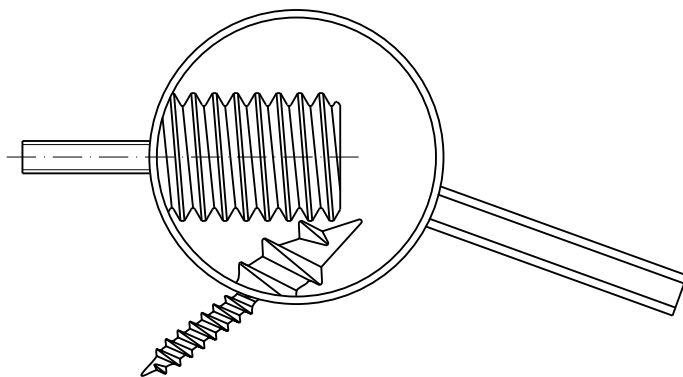

<b>038.01</b>		<b>038.04</b>	
<b>038.02</b>		<b>038.05</b>	
<b>038.03</b>		<b>053.52</b>	

- i
- 011
- 012
- 013
- 014
- 015
- 021
- 022
- 023
- 024
- 031
- 032
- 033
- 034
- 035
- 036
- 037
- 038
- 048
- 049

- i
- 011
- 012
- 013
- 014
- 015
- 021
- 022
- 023
- 024
- 031
- 032
- 033
- 034
- 035
- 036
- 037
- 038
- 048
- 049

ZN: 970A	038.01
	SD

**Szpilka**  
**Шпилька с метрической резьбой**  
**Metric threaded rod**

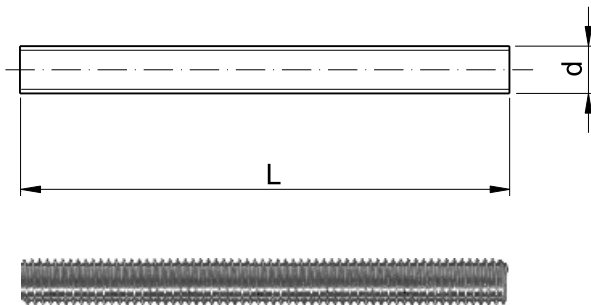

d	M5	M6	M8	M10	M12
L					
20	●	●	●		
25	●	●	●	●	
30	●	●	●	●	
40	●	●	●	●	
50	●	●	●	●	
60	●	●	●	●	●
70	●	●	●	●	●
80		●	●	●	●
90		●	●	●	●
100		●	●	●	●
110				●	●
130				●	●
140				●	●
150				●	●
160				●	●
170				●	●
180				●	●
190				●	●
200					●
260				●	●
320				●	●
330				●	●
350				●	●
360				●	●
400				●	●
420				●	●
530				●	●
600				●	●
610				●	●

# Szpilka dwustronna

Шпилька с двухсторонней метрической резьбой

Double side metric threaded rod

038.02

ZN: 970B

SD

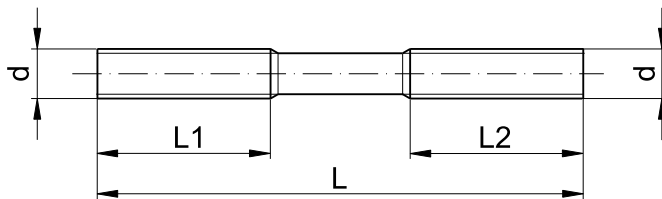

d	M5	M6	M8	M10
L1,L2	~35	~40	~40	~40
L				
80	●			
90	●			
100	●	●	●	●
110	●	●	●	●
120	●	●	●	●
130	●	●	●	●
140	●	●	●	●
150	●	●	●	●

i

011



012



013



014



015



021



022



023



024



031



032



033



034



035



036



037



038



048



049

- i
- 011
- 012
- 013
- 014
- 015
- 021
- 022
- 023
- 024
- 031
- 032
- 033
- 034
- 035
- 036
- 037
- 038
- 048
- 049

ZN: 971	<b>038.03</b>
	SD

## Szpilka z obustronnym gwintem do drewna

Шпилька с двухсторонней резьбой для дерева

Double side wood threaded rod

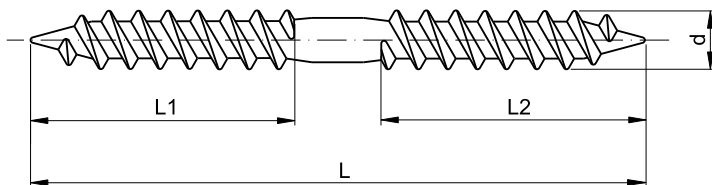

d	6,0	7,0
L	70	70
L1,L2	30	30

# Szpilka z gwintem do drewna i metrycznym

Шпилька с резьбой для дерева и метрической

Metric and wood threaded rod

038.04

SDM

ZN: 972

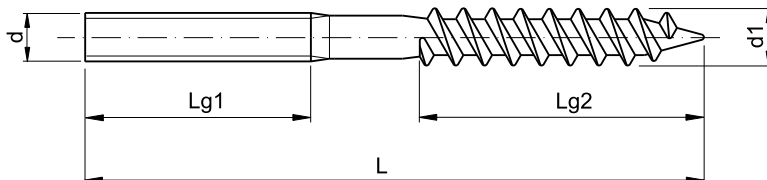

		d	M4
		d1	4,5
Lg1	Lg2	L	
8	11	22	●
8	14	25	●
8	28	40	●

		d	M5
		d1	5,5
Lg1	Lg2	L	
10	18	30	●
10	24	35	●
18	28	50	●
25	30	60	●

		d	M6
		d1	6,5
Lg1	Lg2	L	
17	20	40	●
17	25	45	●
17	30	50	●
24	25	55	●
24	30	60	●
24	40	70	●
29	49	80	●
36	49	90	●
36	49	100	●
36	49	110	●
36	49	120	●

		d	M8
		d1	8,0
Lg1	Lg2	L	
14	20	40	●
15	32	50	●
25	29	60	●
25	39	70	●
25	49	80	●
25	59	90	●
30	59	100	●
59	50	120	●
60	58	130	●
59	59	130	●
59	59	140	●

		d	M10
		d1	10,0
Lg1	Lg2	L	
17	39	60	●
17	49	70	●
26	49	80	●
36	49	90	●
36	59	100	●
46	59	120	●
59	59	140	●

- 011
- 012
- 013
- 014
- 015
- 021
- 022
- 023
- 024
- 031
- 032
- 033
- 034
- 035
- 036
- 037
- 038
- 048
- 049

- 011
- 012
- 013
- 014
- 015
- 021
- 022
- 023
- 024
- 031
- 032
- 033
- 034
- 035
- 036
- 037
- 038
- 048
- 049

ZN: 973	<b>038.05</b>
	<b>SDM</b>

## Szpilka z gwintem do drewna i metrycznym z przetłoczeniem sześciokątnym

Шпилька с резьбой для дерева и метрической, с шестигранной частью под ключ

Metric and wood threaded rod with hexagon

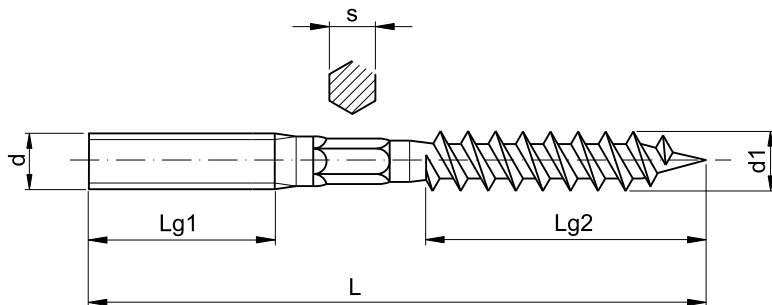

Lg1	Lg2	L	d	M8
			d1	s
15	30	60	8,0	6,0
15	44	70	●	●
25	39	80	●	●
15	49	90	●	●
25	59	100	●	●
50	49	120	●	●
50	59	140	●	●

Lg1	Lg2	L	d	M10
			d1	s
19	39	70	10,0	8,0
19	49	80	●	●
30	49	100	●	●
30	59	110	●	●
37	59	120	●	●
59	59	130	●	●
59	59	140	●	●

# Pręt gwintowany

Прут с резьбой

Threaded rod

DIN: 975

ZN: 880B

053.52

St

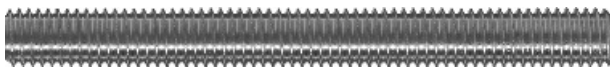
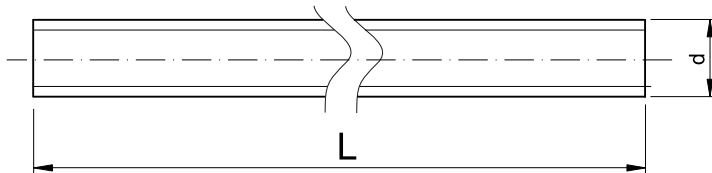

d	M3	M4	M5	M6	M8	M10	M12	M14	M16	M18	M20	M24	M27	M30
L														
1000	●	●	●	●	●	●	●	●	●	●	●	●	●	●
2000				●	●	●	●	●	●	●	●			

i

011



012



013



014



015



021



022



023



024



031



032



033



034



035



036



037



038



048



049



i

011



012



013



014



015



021



022



023



024



031



032



033



034



035



036



037



038



048



049

